

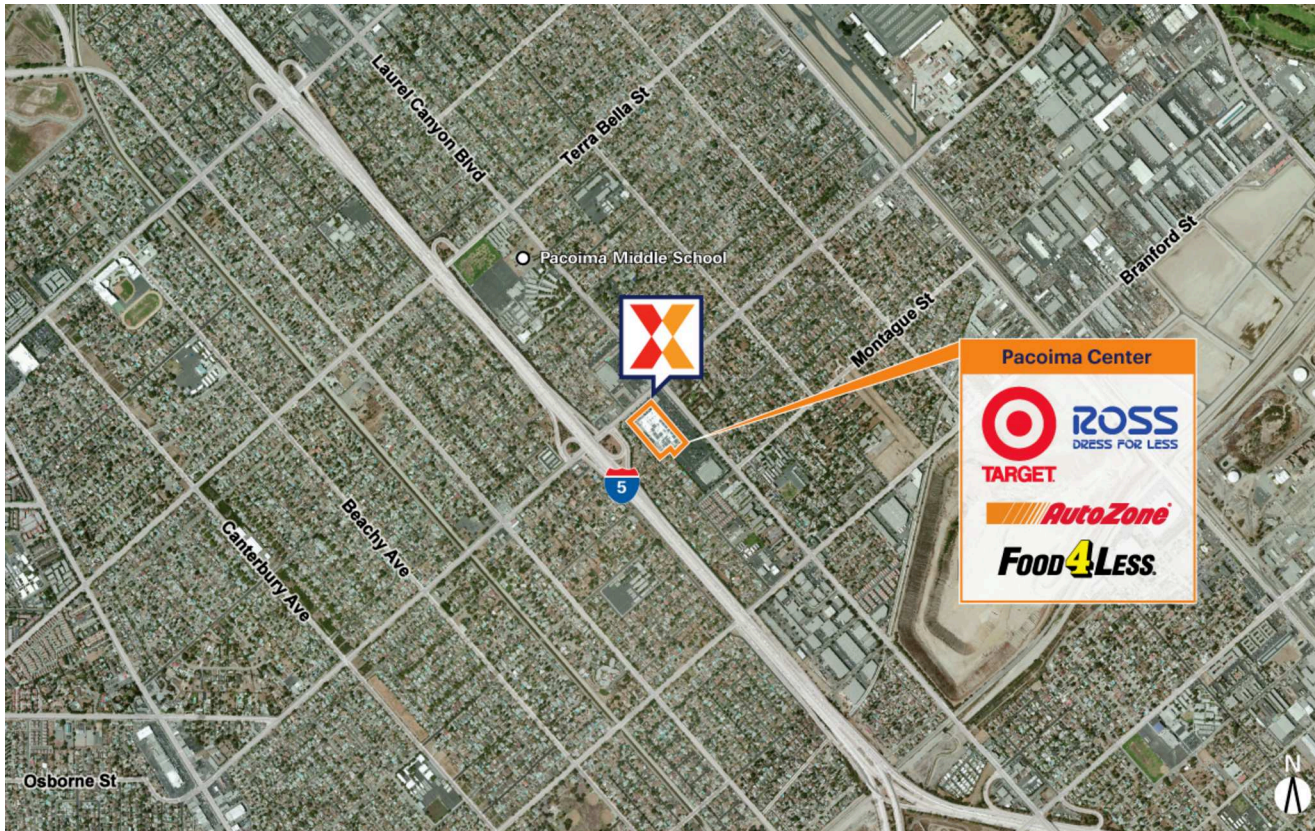

Los Angeles-Long Beach-Anaheim, CA
PACOIMA CENTER

34.245522, -118.419097
 9727 Laurel Canyon Drive & Osborne Stree | Pacoima, CA 91331



CENTER SIZE: 202,773 SF



DEMOGRAPHICS	1 MILE	3 MILE	5 MILE
👤	34,799	275,933	657,898
🏠	7,486	67,323	180,704
💰	\$77,189	\$67,539	\$70,973

Market-dominant center anchored by Food 4 Less, Target & Ross Dress for Less, drawing an estimated 10,000 visits/day and 3.7M visits/year

Surrounded by a dense population of 275,000+ and a daytime population of 231,000+ within 3 miles

Located at one of the area's busiest intersections of Laurel Canyon Blvd and Osborn St with visibility from I-5 and proximity to 118 Freeway

Los Angeles-Long Beach-Anaheim, CA
PACOIMA CENTER

34.245522, -118.419097
 9727 Laurel Canyon Drive & Osborne Street | Pacoima, CA 91331

AVAILABLE SPACE

7

CURRENT RETAILERS

1	Chase	1,500 SF
2	Magiland Dental Grp of Pacoima	3,900 SF
3	Ross Dress for Less	25,500 SF
4	AutoZone	15,840 SF
05	Target	103,109 SF
6	Food 4 Less	52,924 SF

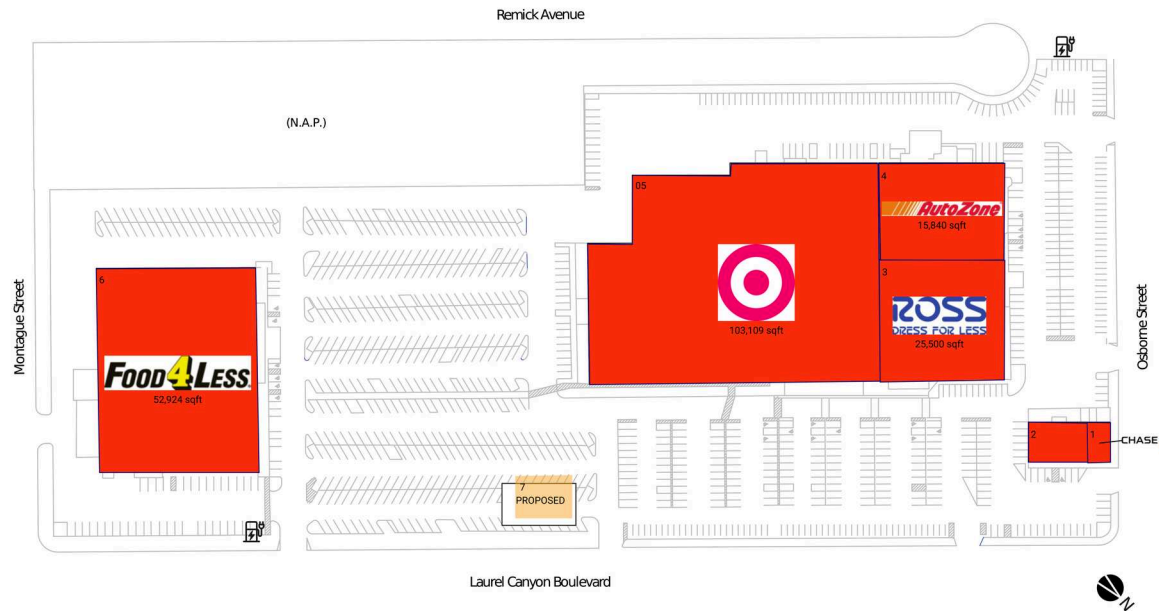

4060 - 02.13.25